

## CAR CENTRAL ARMREST DVD PLAYER

# USER'S MANUAL



**Compatible with**  
**MP4/MP3/DVD/SVCD/VCD/DVCD/CD/WMA/JPEG**  
**NATIVE 32/8 GAME**

## USER MANUAL

### Content

Precautions .....	1
Notice before operation .....	2
Accessories .....	3
Precautions for remote controller .....	3
Features .....	4
Video disk type .....	4
System connection and installation .....	5
Key parts in front of the player .....	6
Key parts at the side of the player .....	7
Description for pressing-keys of remote controller .....	8
<b>Basic Operation</b> .....	9-11
USB and card reading .....	11
<b>Function explanation</b> .....	12
Menu/PBC .....	12
Title .....	12
Display .....	12-15
Subtitle .....	16
Audio .....	16-17

## USER MANUAL

Angle .....	16
Zoom .....	16
Repeat.....	16
Direction Buttons .....	17
Program.....	17
Mute .....	17
Pause .....	17
Source .....	17
TFT/MENU .....	18
<b>Menu operation</b> .....	18-20
Description for playing MP4/MP3/WMA/JPEG/TXT disks.....	21
Electronic Album.....	22
Playing JPEG Disks .....	22
Playing MP3 & JPEG Disks .....	22
<b>MPEG4 decoding technology</b> .....	23
Description for Playing MP4 Disks .....	23
<b>Troubleshooting</b> .....	24
<b>Technical specifications</b> .....	25

## USER MANUAL

### A. Precautions

Thank you to buy our product, please read the operation instruction carefully prior to operation so as to use the player correctly, and please keep it appropriately for future reference.

#### Warning

- For the sake of your safety, do not watch the video image or open the display in driving.
- Without the approval of authorized organization, any charging or rebuilding for the player shall cause troubles for user.

#### Caution

- The product has dangerous high voltage inside, non-professional personnel shall be not allowed to dismantle it and repair. If any trouble is found, please turn to the professional personnel or our authorized maintenance center.
- The player is equipped with TFT color LCD, it is frangible, to be careful in delivering and installing.
- Do not clean the device by corrosive chemical detergent, soft cloth is recommended.
- The operating voltage is DC 12V(+2V), the player shall be worked abnormally or be damaged if the voltage higher or lower than the allowed range.
- The player is equipped with radium emitting system, please read the instructions carefully for right operation and keep it well for future reference. If maintenance is needed, please contact the professionals, do remember to operate it as per the correct operating procedure to avoid the harmful light beam, in order to prevent the direct radium light beam, do not open the enclosure without permission.

#### Special Tips

- In using, the LCD might have a few bright spots on its screen, which is a very normal phenomenon in the active matrix display technology, and it doesn't mean the product has any fault or trouble.

## USER MANUAL

### B. Notice before operation

#### Safety

- Before operating the product, please check the voltage of your car and it should be consistent with the working voltage of the player.
- Do grasp the powerplug firmly in connecting or disconnecting to the power, do not pull the power line by force.
- The radium emitting light beam used by the product is harmful to eyes, do not dismantle the enclosure without permission and only the professional technicians are allowed to conduct the repair or maintenance.

#### Placement

- Please operate the product in proper temperature, the storage temperature should be  $-30^{\circ}\text{C}$  to  $75^{\circ}\text{C}$ , and the working temperature should be  $-10^{\circ}\text{C}$  to  $55^{\circ}\text{C}$ .
- To prevent dust falling on the laser head, it shall affect the playing effect, if the head is dusted, please use the laser head cleaning disk to clean. Refer to the instructions of purchased cleaning disk for detailed operation.
- It should be damp-proof, crash-proof and pressure-proof.

#### Dew

In the below conditions, moisture shall be formed on the lens (dew formation):

- Carry the player from the cold place to warm place;
- In the condition of big temperature difference such as at the moment of opening the heating device;
- If the dew is formed, it shall affect the normal work of the player, and please remove out the disk, lay the player on table for one hour under the condition of connecting to power so as to vapor the moisture.

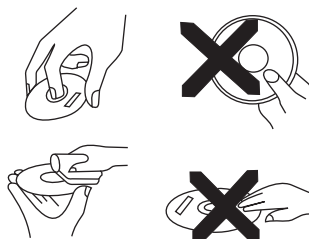

#### Precautions for disk

- In order to keep the disk clean, please take the edge of disk and do not touch its surface;
- Do not adhibit any paster or tape on the disk;
- Keep the disk away from direct sunshine or heat source;
- Please place the disk in the disk box after being used;
- Before playing the disk, if the disk is dirtied, please clean it with soft cloth from the center to out;
- Do not use volatile oil and thinner to clean the disk.

## USER MANUAL

### Accessories

Please check the following accessories after opening the package.

1. Remote controller	1 Set
2. USER'S MANUAL	1 Set
3. Power line for cigar lighter	1 Set
4. Power connection line	1 Set
5. Audio connection line	1 Set
6. Bracket(Plastic)	1 Set or 2 Sets
7. Bracket (Hardware)	1 Set or 2 Sets
8. Mounting sheet	2 Sets
9. Native game disk	1 Set

### K. Precautions for remote controller

- For the first use, please first pull off the PVC sheet so as to electrify the remote controller;
- Take notice to protect the remote controller to avoid damaging;
- If there exists barrier between the player and the controller, the remote controller might be out of use;
- Do not place the remote controller under the strong light, or it might cause the unavailability of the device;
- Please operate the remote controller in the effective distance.

# System connection and installation



(1)



(2)



(3)

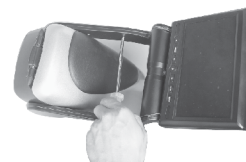

(4)

1. Take the screws off the bracket arms (See figure 1)
2. Open the two side covers
3. Adjust the iron piece and across to back (See figure 2)
4. Adjust the notch angle, it can be adjust the rotational range of screen (See figure 2 □ 3)
5. Fix two side cover after finishing installation(see figure 4)
6. The distances between two bracket can be adjustable.

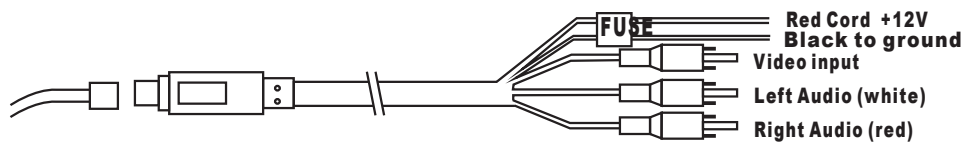



**Key parts in front of the player**



- 1、Pause/Play
- 2、TFT menu
- 3、Previous
- 4、Power/DVD/USB/TF/HDMI
- 5、Next
- 6、AoL-
- 7、AoL+

**Key parts at the side of the player**



- 1、12V Power jack
- 2、A/V output
- 3、USB port
- 4、HDMI
- 5、TF
- 6、350° degree swivel bar
- 7、Bracket left foot
- 8、Bracket right foot

# Description for pressing-keys of remote controller

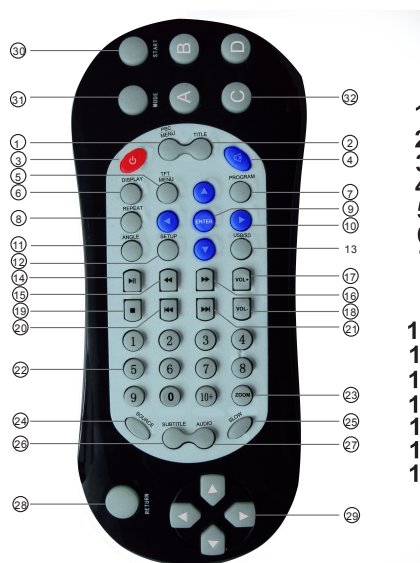

- |                  |                   |
|------------------|-------------------|
| 1.Menu/PBC       | 17.Volume+        |
| 2.Title menu     | 18.Volume-        |
| 3.Power          | 19.Stop           |
| 4.Mute           | 20.Previous       |
| 5.TFT Menu       | 21.Next           |
| 6.Display        | 22.Number key     |
| 7.Program        | 23.Zoom           |
| 8.Repeat         | 24.Source         |
| 9.Enter          | 25.Slow           |
| 10.Direction key | 26.Subtitle       |
| 11.Angle         | 27.Audio          |
| 12.Setup         | 28.Game return    |
| 13.USB/SD        | 29.Game direction |
| 14.Play/Pause    | 30.Game start     |
| 15.Fast forward  | 31.Game mode      |
| 16.Fast backward | 32.Game A/B/C/D   |

Notice: due to discrepancy of disc recording when you operate to use the press buttons , some of them have no function of disc , screen will be shown “”

## Basic Operation

Make sure that you have correctly connected your unit as described earlier in this book.

Turn on the power,and put the disc in.

- 1 press power button to turn ON (Power Indicator is OFF), display is ON and player will start loading the disc. Long press to turn off, Short press to select.
- 2 Press Open button to eject the disc tray out, then insert the disc, press open button again to close.



The player will recognize the different formats of the discs, and disc mark will be displayed on the top left side of the screen.

- 3 While playing DVD discs, please select one item in DVD menu or title menu. while playing VCD2.0 or CD,this player plays one by one.
- 4 Press Direction Buttons or the Number Buttons to select the desired item, then press Enter or Play to start.
- 5 The player will play automatically. Press Pause to stop temporarily, press pause again or play to cancel pause. while playing DVD disc, press stop for memory stop, press Play for memory play, press Stop twice to stop playing.

**Note:** To stop playing DVD by pressing Stop for twice.

## **Functions Explanation**

### **Menu/PBC**

- (1) Press Menu/PBC to return to the main menu or the Title menu while playing DVD disc.
- (2) While playing VCD disc, Press Menu/PBC (Unfunctional while playing DVD)
- (3) Only return to the main menu to select one song in PBC-on mode.
- (4) Pressing Number buttons to select one song in PBC-off mode.

### **Title**

- (1) While playing DVD disc, press Title to enter into title menu directly, select the desired item by pressing the Direction buttons or Number buttons.
- (2) While playing VCD2.0, press Title to return to previous menu; however this function is disabled in PBC-off mode (Only for functional disc).

### **Display**

User can check the elapsed time or remaining time of current title and chapter by pressing Display, Press Display continuously, the screen shows as below:





**Note:** This feature setting is valid only for the current disc which has multi-language settings.

### **ANGLE**

If the disc contains scenes recorded at different camera angles, you can change to a different camera angle during playback. Press ANGLE repeatedly during playback to select a desired angle. (Only for the functional disc)  
⊙ will show on the screen when this function is not available on the disc.

### **Zoom**

In this mode, the dynamic or still picture can be zoomed in at most by 4 folds. Press Zoom for three times, the picture is zoomed in by 2X, 3X, 4X folds per order. And press Zoom again to return to the normal playing mode.

### **Repeat**

- (1) While playing DVD disc, press Repeat for the first time to repeat playing one chapter, press Repeat for the second time to repeat playing one title, press Repeat for the third time to repeat playing the entire disc, and press Repeat to cancel.
- (2) In PBC off mode:  
While playing VCD disc, press Repeat for first time to repeat one song. Press Repeat for the second time to repeat the entire disc. Press Repeat for the third time to cancel.

### **Direction Buttons**

Press Direction Buttons to make free selection in title, content and setup menu easily.

**Note:** Direction buttons on the player can perform Fast Forward/Fast Backward, Previous/Next functions.

### **Program**

Press Program to enter into program menu, input the number of the title, the chapter or a song.

Press direction button to select the track you want to start playing.

To cancel program function, press Program to enter into program menu and select Stop.

### **Mute**

Press Mute one or more to select mute on or mute off.

### **Pause**

Press pause to stop playing temporarily, press again pause or play to replay.

### **Source**

Press source to shift disc-playing mode to AV-input, or AV-input to disc-playing mode, when there is no signal, the screen will be blue.

**Note:** Once the unit restarts in AV-IN mode, it will be disc-playing mode.

## **TFT/MENU**

Methods of adjusting Brightness, Contrast, Color in console:

Step 1

Press TFT MENU key to select Brightness, Contrast and color.

Step 2

Press direction key to adjust.

Step 3

Select EXIT to save the changed setup.

### **Menu operation**

#### **Setup**

The setup page includes General Setup, Password Setup, Preference Setup Page and Exit.

Setup page will show on the screen by pressing Setup.

#### **Operating methods:**

Press Setup to enter into Setup page,







**Troubleshooting**

Troubles	Solutions
No response	1. Check the power connection; 2. Check the auto power is opened; 3. Check the power is opened.
No sound	1. Check the volume is on the min. position or in mute state; 2. Whether it's in FM state? Switch it to be FM OFF state by pressing the FM key on remote controller or panel; 3. No sound output in the following states: Pause/Fast Forward/Fast Backward/ Stop.
Image	1. Check whether the player is in AV input state, press DVD/AV to switch it to be DVD state; 2. Check if the brightness setup is appropriate.
The disk couldn't be read	1. Check whether the disk has been loaded and the side with label is placed upward; 2. The disk is damaged or dirtied, please load another disk or clean the disk; 3. The region codes of disk and player are different; 4. The disk format is wrong.
Improper image size	1. Reset the TV system. 2. Select the corresponding screen format from the setup menu.
The track couldn't be selected	1. Some sections of some disks are not allowed to interrupt its set playing order.
The remote continueroller refuses to work	1. Check whether there is any barrier between the remote controller and player; 2. The remote controller doesn't aim at the receiving head of player; 3. Check whether the battery is installed correctly; 4. Check whether the battery has enough electricity.

**Do not dismantle the device to repair without permission!**

**Technical specifications and parameters**

Product Name	CAR CENTRAL ARMREST DVD PLAYER
Disk type (signal source)	MP4/MP3/ DVD/SVCD/VCD/DVCD/CD/CDG/WMA/JPEG CD-R/CD-RW (these two types of disk should be played by the above coding formats)
Display	8 inches color TFT-LCD(16:9)
Output Port	Audio: stereo Video: complex video signal output (AV) USB port TF/MDMI CARD PORT
Video System	PAL/NTSC/Auto
Video Characteristics	Video Characteristics: 1.0Vp-p (75ohm)
Audio Characteristics	Frequency characteristics: 20-20KHZ ( 1dB ) SNR: >90dB Total harmonic distortion: <0.01%
Power Voltage	DC:12V/1A
Power Consumption	Approx: 7 W
Working Temperature	- 20 ℃ ~ +60 ℃
Working Humidity	15~75% ( No water drop is coagulated )
Net Weight	Approx: 1KG
Dimensions	□(L) 180mmX(W)135mmX(D)35.5mm    □(L)212mmX(W)153.5mmX(D)33mm

Your attention please:

The design and specifications are subject to change without notice